Installation Instructions for #40 Snow Guard
(Slate, Synthetic Slate, Cedar)

Snow Guard Placement Less Than 75 psf Snow Load

On Synthetic Slate Roofs with a 75 psf or less Ground Snow Load and a 24/12 or less roof pitch use the **Standard 2 X 4 Layout Using 12 Snow Guards Per Square.**

Page 2 shows a sample installation of a roof with a rafter length greater than 15', a roof pitch of 24/12 or less and a Ground Snow Load of less than 75 psf. All snow guard installations must have the standard three-row pattern along the eave. Remaining snow guards should be evenly spaced between the top of the three-row pattern to within 10' of the ridge. If the rafter length is less than 15' you only need the three-row pattern which requires 17 snow guards per 10' of eave.

Installation

1. The third course of slate is installed in the usual manner.
2. The snow guard is placed on the synthetic slate low enough so that the next course lies properly over the top of the snow guard. The top of the cap should be 3 times the thickness of the slate or a minimum of 5/8" below the bottom of the next course of slate.
3. Horizontal spacing is 24" on center.
4. Use two fasteners of compatible material on each snow guard. The fasteners are inserted into the two holes on the snow guard strap and through the slate into the roof deck.
5. Install two more courses of slate and then install another row of snow guards offset 12" horizontally from the first row.
6. Supplemental rows are installed at 48" on center horizontally and 3 courses of slate vertically.
7. Repeat these steps for the entire snow guard layout.



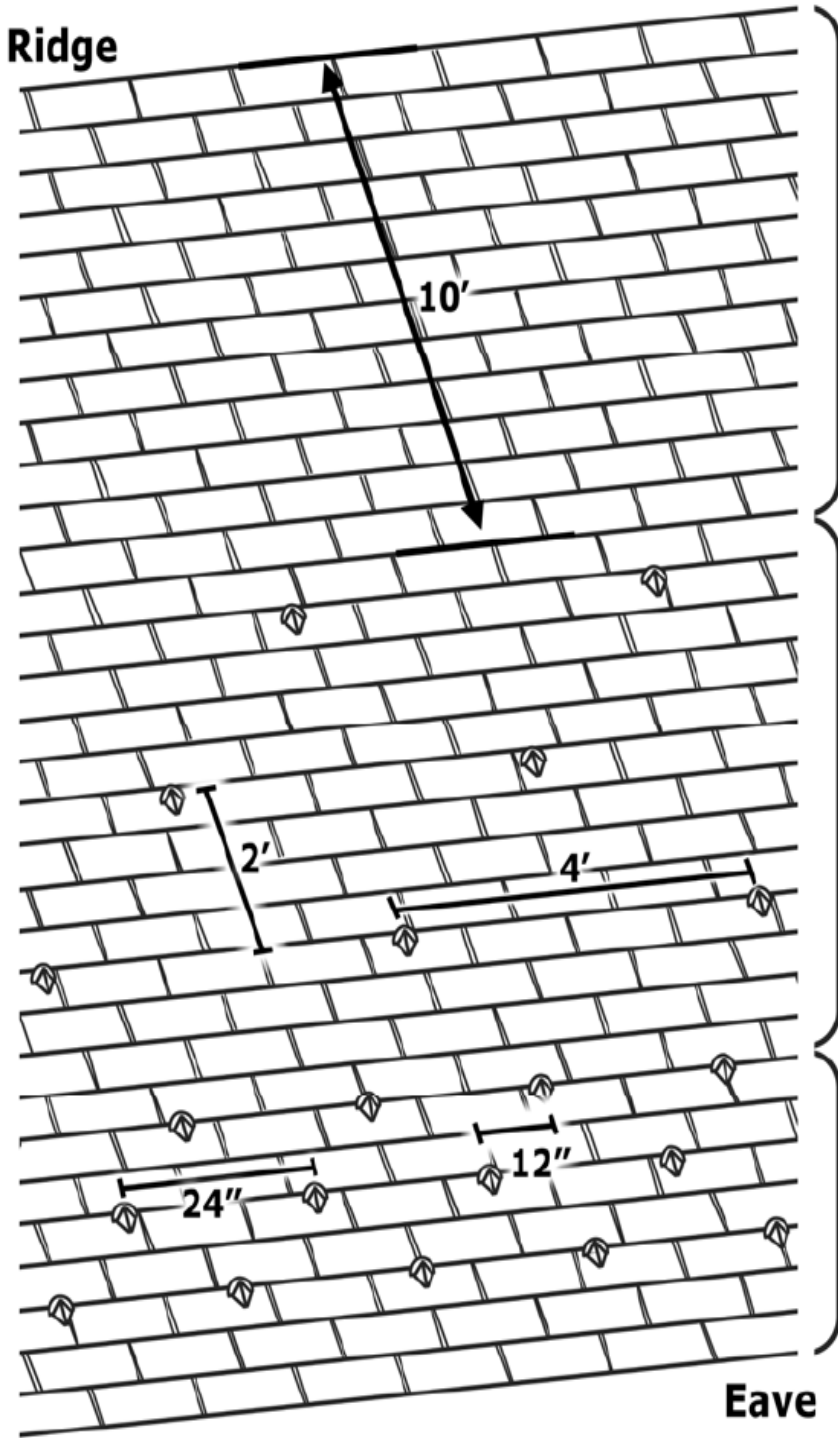

2 X 4 Layout – less than 75 psf Ground Snow Load and less than 24/12 roof pitch using 12 snow guards per square.

Top ten feet of rafter does not generally require snow guards except in extreme snow load areas.

2 X 4 Supplemental Pattern
(Alpine standard layout)

This pattern is for installations using 12 snow guards per square including the standard three-row pattern. Space rows 2' vertically and 4' horizontally to within 10' of the ridge.

Standard Three-Row Pattern – For All Roofs.

Three rows 24" on center horizontally with the middle row staggered 12".



Layout for Extreme Snow Areas Greater Than 75 psf Ground Snow Load

Most snow guard installations will use 12 snow guards per square with our standard 2 X 4 layout. If your project is in an extreme snow area, greater than 75 psf you will need to use one of these layouts. If your Ground Snow Load is between 75 psf and 110 use the 2 X 3 layout. If your Ground Snow Load is from 111 psf to 150 psf use the 2 X 2 layout.

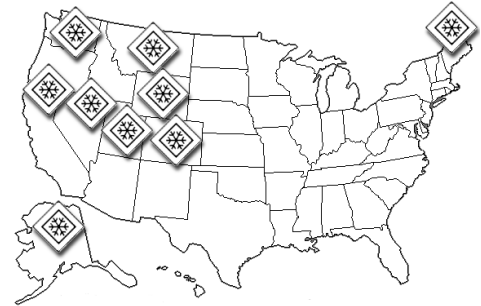

Installation

1. The third course of synthetic slate is fastened to the roof in the usual manner.
2. The snow guard is placed on the synthetic slate with the up slope end of the strap resting on the roof deck above the slate.
3. The snow guard pad should be placed low enough on the synthetic slate so that the next course of synthetic slate (course 4), lays properly over the top of the snow guards, and the pad is set 3 times the thickness of the synthetic slate (or 5/8", whichever is great) below the next course. Horizontal spacing should be 24" on center for the first three courses.
4. Two nails or screws of the same or compatible material as the snow guard are inserted through the two holes at the top of the strap to secure the snow guard to the roof deck.
5. Repeat these steps for the entire snow guard layout.

2 X 3 Pattern - for roofs 75 psf to 110 psf,
17 to 21 snow guards per square.

2 X 2 Pattern - for roofs 111 psf to 150 psf,
22 to 27 snow guards per square.

